

Digital Overload Relays

SPD SERIES - CLASS 1 -60

MODEL NUMBER			SPD06-S	SPD60-S	SPD06-T	SPD60-T
WIRING			SCREW TYPE OR TUNNEL TYPE			
DISPLAY			UNIT MOUNT OR REMOTE MOUNT			
OPERATION TIME			SELECT EITHER REVERSE TIME OR DEFINITE TIME			
CHARACTERISTICS	PROTECTION		OVER CURRENT ADJUSTABLE			
	PHASE FAILURE		3 SEC.			
	REVERSE PHASE		WITHIN 0.1 SEC.			
	ASYMMETRY		5 SEC.			
	STALL		5 SEC.			
	LOCK		WITHIN 0.5 SEC.			
	UNDER CURRENT		3 SEC.			
	GROUND FAULT		WITHIN 0.05 - 1 SEC. SELECTABLE (0.05 - 1.0 SEC.) Z MODELS ONLY			
SHORT CIRCUIT			WITHIN 50MS			
ALARM			VARIABLE (60 - 110% OF THE SETTING CURRENT)			
CURRENT SETTING RANGE (A)			0.5 - 6	5 - 60	0.5 - 6	5 - 60
TIME SETTING RANGE (SEC.)	DEFINITE	DELAY IN STARTING	0 - 60 SEC.			
	TIME	DELAY IN OPERATING	0 - 30 SEC.			
	INVERSE TIME		0 - 60 SEC.			
	RESET		MANUAL RESET			
TOLERANCE	CURRENT		+ 5%			
	TIME		± 5% (OR ± 0.5% SEC.)			
OPERATING POWER			AC 120V			
			60HZ (50HZ)			
AUX. CONTACT	OL	2-SPST	3A/250VAC RESISTIVE LOAD			
	AL	SPST	3A/250VAC RESISTIVE LOAD			
INSULATION RESISTANCE			OVER DC500V 100 MΩ			
SURGE IMPULSE VOLTAGE (IEC1000 - 4-5)			1.2 X 50us 6KV (APPLY STANDARD WAVE FORM)			
FAST TRANSIENT BURST (IEC1000 - 4-4)			2.5KV/5MIN			
ENVIRONMENT	TEMPERATURE	OPERATION	-25 - 70°C			
		STORAGE	-30 - 80°C			
	HUMIDITY	30 - 90% RH (NON-CONDENSING)				
DISPLAY	7 - SEGMENT		3 PHASE CURRENT AND FAULT INDICATION			
	BAR-GRAPH		60 - 110% OF REAL LOAD CURRENT			
MOUNTING TYPE			3MM DINRAIL OR PANEL MOUNT			

Digital Overload Relays

PRICE AND SELECTION GUIDE

SEPARATE MOUNT - ALL CONTACTORS

MODEL NUMBER	GFI PROTECTION	SETTING RANGE	WIRE METHOD	LIST PRICE
SPD-06S	NO	0.5~6	CT TUNNEL OR SCREW	CF
SPD-06SZ	YES	0.5~6	CT TUNNEL OR SCREW	CF
SPD-60S	NO	5~60	CT TUNNEL OR SCREW	CF
SPD-60SZ	YES	5~60	CT TUNNEL OR SCREW	CF

- Separate 120VAC control source is required for operation. Operational CT's can be used for higher current rated contactors.
- Z Includes ground fault C.T. protection. See page 1-40 for ground fault C.T. information.

OPTIONAL SPD DISPLAY DOOR MOUNT KIT

KIT PART NUMBER	DESCRIPTION	LIST PRICE
SPD-C1	NEMA 1 DISPLAY DOOR MOUNT KIT, 1M CABLE	CF

- Kit includes cable and mounting hardware



SPD GFI CT

ZCT ZERO PHASE SEQUENCE CURRENT TRANSFORMER

RATINGS

TYPE	DIAMETER	RATIO	WEIGHT (KG)	MODEL
ZCT, D30, SPD-Z	30	200MA/100MV	0.5	LZT-030
ZCT, D50, SPD-Z	50	200MA/100MV	0.7	LZT-050
ZCT, D65, SPD-Z	65	200MA/100MV	0.9	LZT-065
ZCT, D80, SPD-Z	85	200MA/100MV	1.5	LZT-080

DIMENSIONS

MODEL	A	B	C	D	E	F	G	H	I
LZT-030	30	25	108	100	114	7	32	32	6
LZT-030	50	25	131	100	122	7	32	36	6
LZT-030	65	26	143	114	133	7	39	37	6
LZT-030	80	34	174	160	180	7	40	40	6

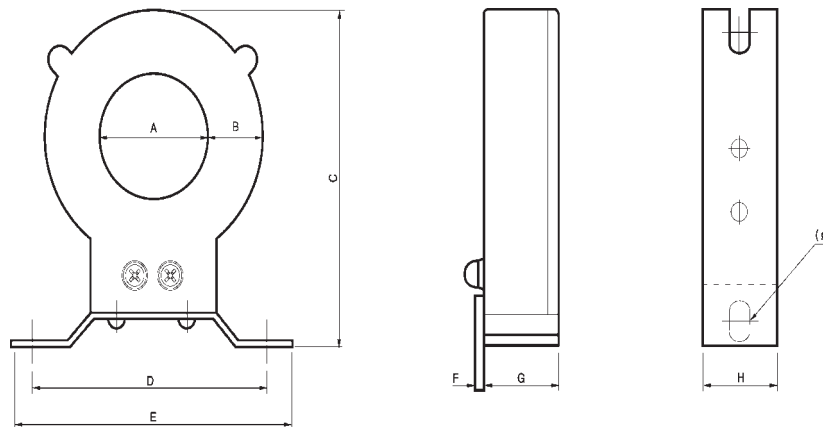

Mounting Dimensions

SPD DIGITAL MOTOR PROTECTION RELAYS

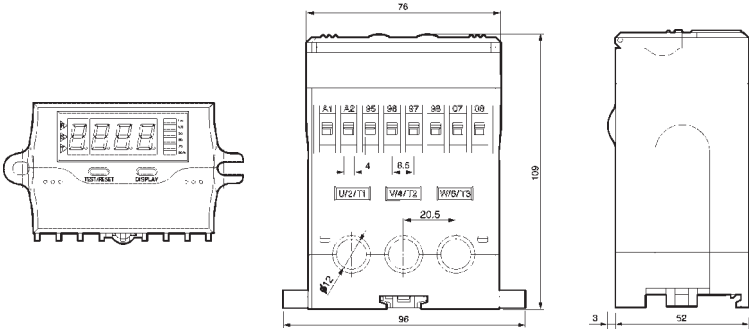
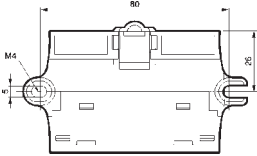
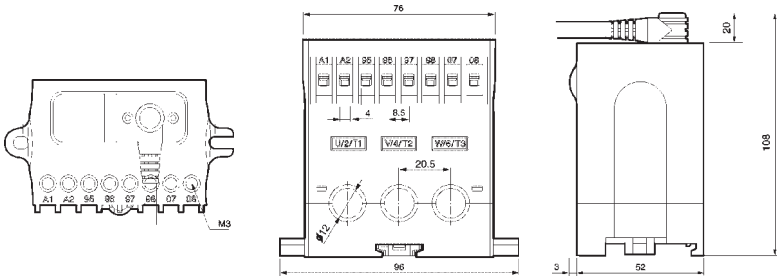
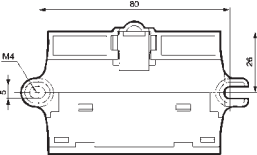
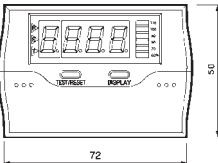
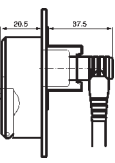
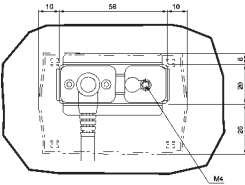
TYPE AVAILABLE	EXTERNAL DIMENSIONS	MOUNTING DIMENSIONS															
<p>SPD-06S SPD-06SZ</p>	<p>0.56Kg</p>  <p>*Wire size to penetrate a CT*: below 22[mm²]</p>	 <table border="1" data-bbox="1252 957 1430 1094"> <tr> <td>R/1/L1</td> <td>S/3/L2</td> <td>T/5/L3</td> </tr> <tr> <td>A1</td> <td>A2</td> <td>95</td> </tr> <tr> <td>96</td> <td>97</td> <td>98</td> </tr> <tr> <td>07</td> <td>08</td> <td></td> </tr> <tr> <td>U/2/T1</td> <td>V/4/T2</td> <td>W/6/T3</td> </tr> </table>	R/1/L1	S/3/L2	T/5/L3	A1	A2	95	96	97	98	07	08		U/2/T1	V/4/T2	W/6/T3
R/1/L1	S/3/L2	T/5/L3															
A1	A2	95															
96	97	98															
07	08																
U/2/T1	V/4/T2	W/6/T3															
<p>SPD-60S SPD-60SZ</p>	<p>0.5Kg</p> 	 <table border="1" data-bbox="1252 1425 1430 1562"> <tr> <td>R/1/L1</td> <td>S/3/L2</td> <td>T/5/L3</td> </tr> <tr> <td>A1</td> <td>A2</td> <td>95</td> </tr> <tr> <td>96</td> <td>97</td> <td>98</td> </tr> <tr> <td>07</td> <td>08</td> <td></td> </tr> <tr> <td>U/2/T1</td> <td>V/4/T2</td> <td>W/6/T3</td> </tr> </table>	R/1/L1	S/3/L2	T/5/L3	A1	A2	95	96	97	98	07	08		U/2/T1	V/4/T2	W/6/T3
R/1/L1	S/3/L2	T/5/L3															
A1	A2	95															
96	97	98															
07	08																
U/2/T1	V/4/T2	W/6/T3															
 		 <p>Panel cutting size</p>															

Provided by Northeast Power Systems, Inc.
www.nepsi.com

- Dimensions are in mm (1 inch = 25.4 mm).
- In extension type, the digital SPD is calibrated with combining the display unit and main body so, please be cautious not to combine the display unit and main body with different part numbers.
- The 07-08 contacts are the ZCT input terminal (Digital SPD with ground fault function).